

USER MANUAL/INSTRUCTIONS

REMOVABLE FRONT PANEL EXTRACTOR FAN

Standard / Pull cord / Timer / Humidity Sensor

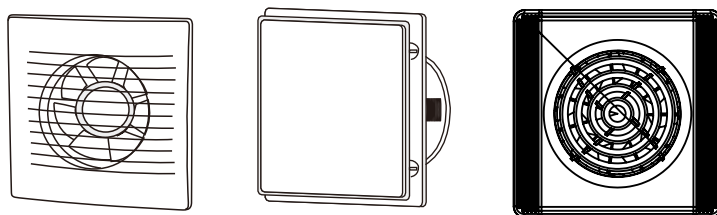

Please read this manual carefully before operating this fan.

This product must not be disposed together with the domestic waste. This product has to be disposed at an authorized place for recycling of electrical and electric appliances. By collecting and recycling waste, you help to save natural resources, and make sure the products is disposed in an environmental friendly and healthy way.



This marking indicates that this product should not be disposed with other household wastes throughout the EU. To prevent possible harm to the environment or human health from uncontrolled waste disposal, recycle it responsibly to promote the sustainable reuse of material resources. To return your used device, please use the return and collection systems or contact the retailer where the product was purchased. They can take this product for environmental safe recycling.



CED
ELECTRICAL
GROUP

44 - 48 FRESHWATER ROAD, DAGENHAM, ESSEX, RM8 1RX (UK)

CED IE 46 Rosemount B. Pk DUBLIN D11 K26W

E: info@cedelectrical.co.uk | W: www.cedelectrical.co.uk

T: 020 8503 8500 | F: 020 8503 8900

LOCATION & INSTALLATION

1. Assure the fans location to be as higher as possible, Min. Height is not less than 2.3m from the ground.
2. Assure the fans to be installed opposite the main sources of air-replacement with at least 30mm from the corner of wall and ceiling.
3. Assure the fans to be mounted as close to the sources of steam or odour as possible, but far enough away from anyone using a bath or shower so as not to be touched.
4. If the fans are to be installed in a room with a gas fire, wall heater etc with a non-balance flue, it is the installer's responsibility to ensure enough replacement air is available so that no air is drawn back through shutter is supplied additionally in the markets.
5. All the fans are to be mounted in different nations, please refer to the local building regulations carefully.
6. This appliance can be used by children aged from 8 years and above and persons with reduced physical, sensory or mental capabilities or lack of experience and knowledge if they have been given supervision or instruction concerning use of the appliance in a safe way and understand the hazards involved. Children shall not play with the appliance. Cleaning and user maintenance shall not be made by children without supervision.
7. If the supply cord is damaged, it must be replaced by the manufacturer, its service agent or similarly qualified persons in order to avoid a hazard.
8. All poles disconnection switch that provided full disconnection under over voltage category III conditions must be incorporated in the fixed wiring in accordance with the wiring rules.

Warning: Must switch off the mains supply before any installation.

WALL INSTALLATION

1. Ensure to choose right voltage shown in the label before connecting with power source.
2. Cut an appropriate size hole in the wall, ensure there are no cables or pipes buried in the wall when cutting. The internal and external wall flush, allow the ducting to slope slightly to the external wall, this will allow drainage of any ingress from rains etc, make good the hole with motor and allow to set before connecting with the installation.

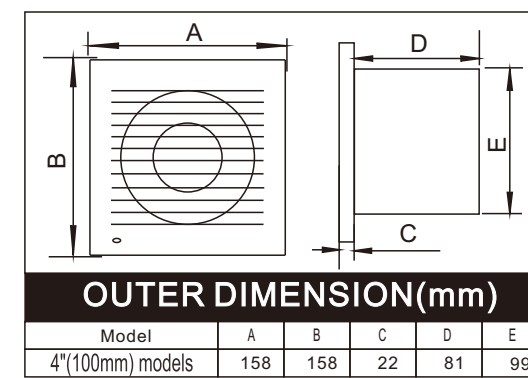
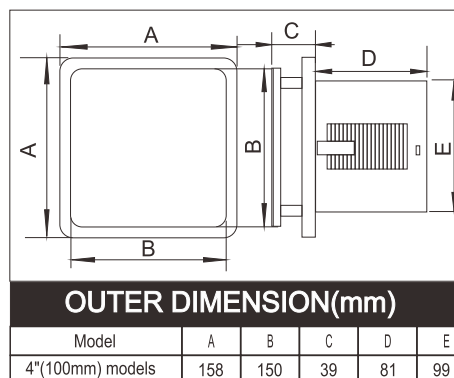
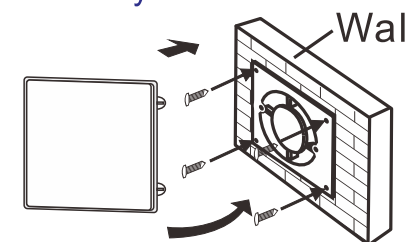

3. Remove the front cover of fan and position the fans against the wall and mark the four fixing points and cable entry, then to drill to suit.

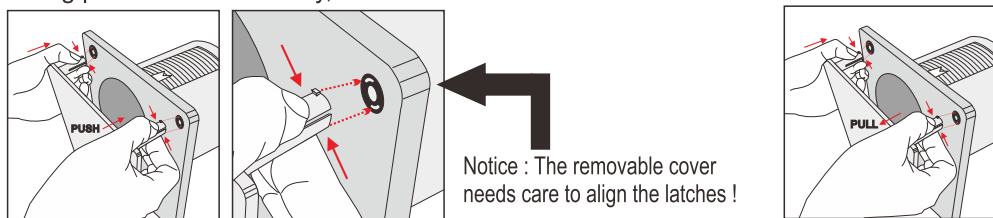

4. Bring the cable to the unit via a double pole switch with a minimum 3mm separate on all poles.
5. Bring the main cable through the cable entry and fix the fan body into position.
6. Fix the front cover and external shutter (External shutter is optional accessory ,not supplied as standard).

CEILING INSTALLATION

1. Position a suitable location for the fan and cut a flush hole in ceiling to size.
2. Remove the front cover of fan follow the step 3(Wall installation)the main cable to the unit and bring the main cable to the unit.
3. Pass the main cable though the cable entry and fix the unit into position using suitable fixings (the fixings not supplied), if the fan may also be fixed to interior ceiling, please use the 2 quick fits to firm the fan into ceiling, the said 2 quick fits are fitted into the two sides of the fan body with screws.
4. Ceiling mounted units must be ventilated to the outside and not into the ceiling to avoid or lofts pace, using a flexible duct and a back draught shutter to suit.

WIRING FOR MODELS WITH TIMER

The fans are double in suited and do not need earth wire.

1. For partition fans, pre-cautions must be taken to avoid and back-flow of gases into the room from open flue gas fire or other appliances.
2. L---connecting to the live.
N---connecting to the neutral.
T ---connecting the light live or switched live

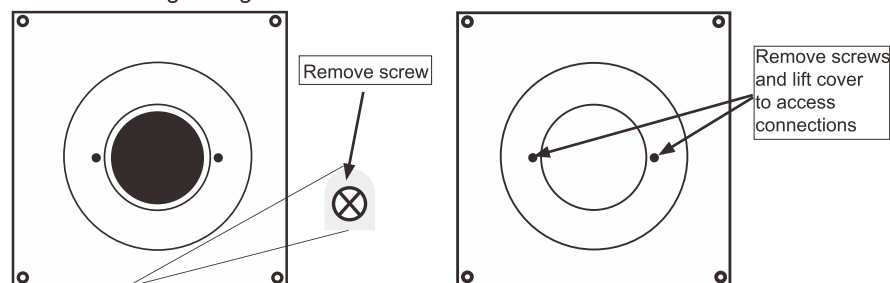

WALL INSTALLATION

1. Ensure to choose right voltage shown in the label before connecting with power source.
2. Cut an appropriate size hole in the wall, ensure there are no cables or pipes buried in the wall when cutting. The internal and internal wall flush, allow the ducting to slope slightly to the external wall, this will allow drainage of any ingress from rains etc, make good the hole with motor and allow to set before connecting with the installation.

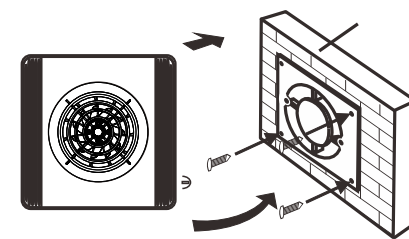

OUTER DIMENSION(mm)

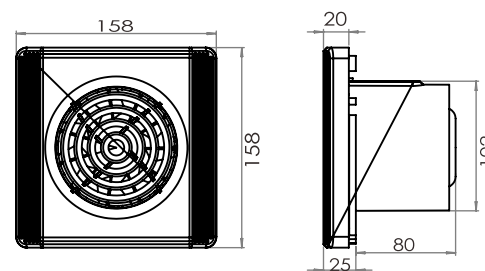

3. Remove the front cover of fan and position the fans against the wall and mark the three fixing points and cable entry, then to drill to suit.



Notice : The removable cover needs care to align the latches !



4. Bring the cable to the unit via a double pole switch with a minimum 3mm separate on all poles.
5. Bring the main cable through the cable entry and fix the fan body into position.
6. Fix the front cover and external shutter (External shutter is optional accessory ,not supplied as standard).

NOTICE: Wiring works must be carried by a qualified electrician.

- Connect the Live (L), Neutral (N) and switched Live (T) (see below)
- Make adjustments to the delay timer for desired setting

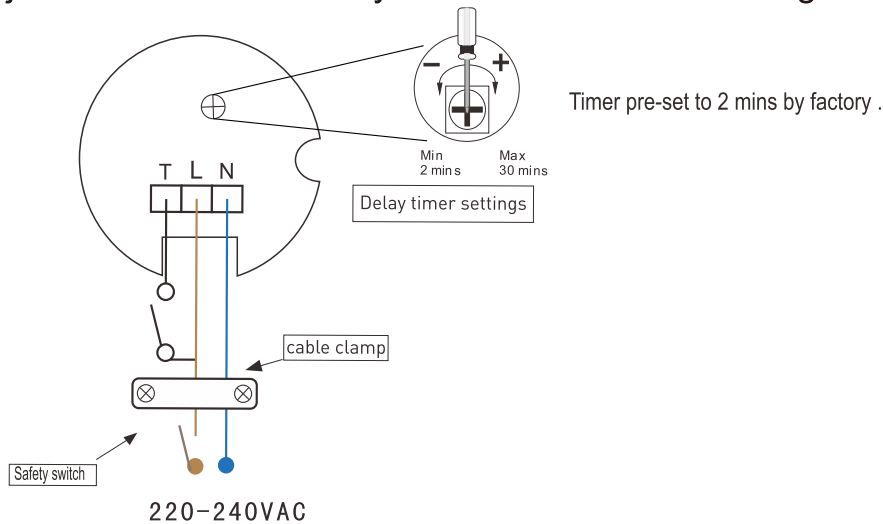

**NOTICE: SCREW TERMINALS MUST NOT BE OVER TIGHTENED!
CAN NOT USE ELECTRIC SCREWDRIVER FOR TERMINALS.**

WIRING FOR MODELS WITH PIR MOTION SENSOR.

The fans are double in suited and do not need earth wire.

1. For partition fans, pre-cautions must be taken to avoid and back-flow of gases into the room from open flue gas fire or other appliances.

2. L---connecting to the live.

N---connecting to the neutral.

NOTICE: THE WORKING TEMPERATURE OF SENSOR IS -15°C TO 35°C

Motion sensor using instruction :

The bathroom fan , when connected to the power supply , will start to work after motion sensor is activated . Then the fan will be turned off with a programmed delay (2-30 min) counted from the last movement detected by the sensor. Meanwhile , the fan returns to stand-by.

Delayed time setting:

1. Turning clockwise, then the time will be longer.

Turning counter-clockwise, then the time will be shorter.

2. The time delayed can be from 2 min to 30 min.

3. Usually, the delay time will be 2 min set by the factory.

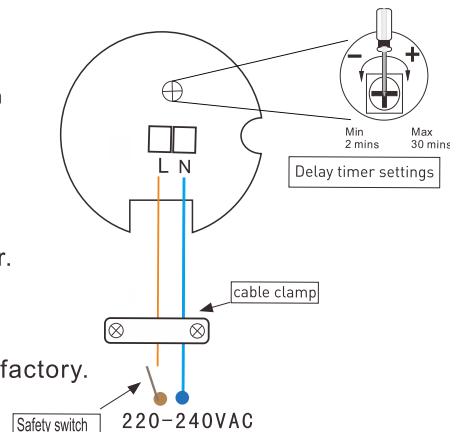

- Connect the Live (L), Neutral (N) and switched Live (T) (see below)
- Make adjustments to the delay timer for desired setting

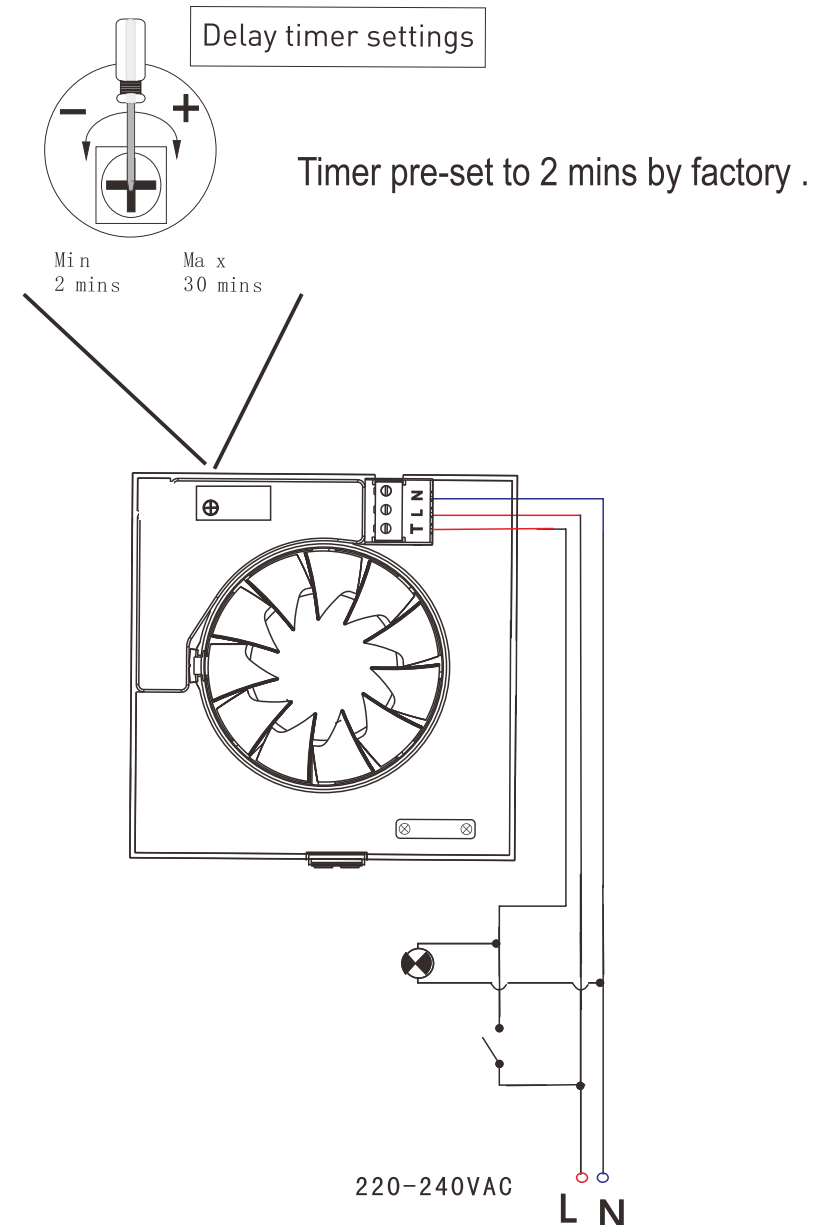

**NOTICE: SCREW TERMINALS MUST NOT BE OVER TIGHTENED!
CAN NOT USE ELECTRIC SCREWDRIVER FOR TERMINALS.**

WIRING FOR MODELS WITH HUMIDITY SENSOR.

Humidity Models provided with an electronic humidistat which can be adjusted from 60% to 90 % RH (Relative Humidity) and with a timer, adjustable between 1,5,15 or 30 minutes. The desired humidity level and run on time are selected by means of 8 dip-switches placed on the printed circuit board, and easily accessible. Each dip-switch has two positions [ON (1) and OFF (0)] which are selected with a small screwdriver supplied with the fan:

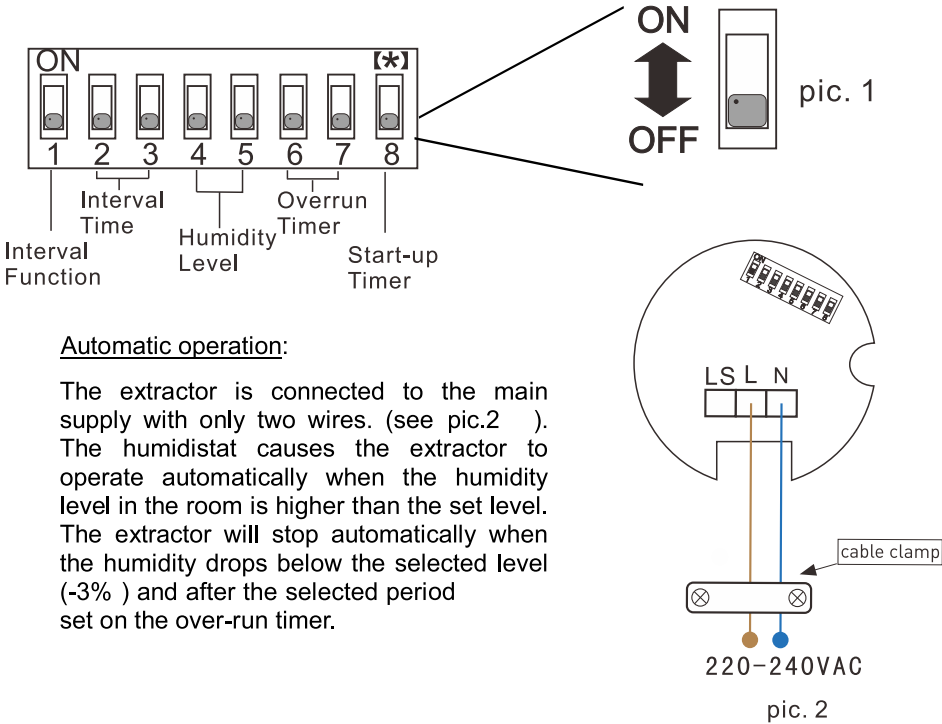

Automatic operation:

The extractor is connected to the main supply with only two wires. (see pic.2). The humidistat causes the extractor to operate automatically when the humidity level in the room is higher than the set level. The extractor will stop automatically when the humidity drops below the selected level (-3%) and after the selected period set on the over-run timer.

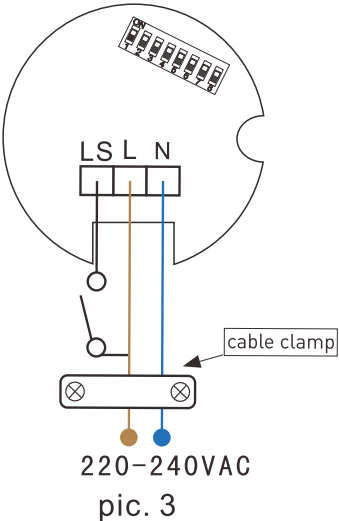

Automatic operation with external switch to override the extractor :

The extractor is connected to the main supply with three wires. (see pic. 3)
Operation as previous "Automatic operation", with the facility to override the humidistat by means of the light switch when the humidity level in the room is lower than the selected level. In this case the extractor continues to operate for the selected period of time (over-run timer) after the switch light has been switched off.

ATTENTION: When the humidity rate is above the selected value, the automatic option takes precedence over the manual and the unit cannot then be switched off using a switch.

Adjust the dip-switch to the required settings

Interval function With the interval function on , the fan operates irrespective of humidity. This is useful to prevent the fan running constantly where humidity levels are consistently high ,for example near the sea. It also allows the fan to operate when humidity levels are consistently low, for example when installed near a heating appliance.
The fan switches on automatically for one hour ,irrespective of the humidity level ,switches off for the interval set ,then switches on again for one hour, etc.

Interval time
The interval time can be set as follows:

Humidity function The humidistat causes the fan to operate when the humidity level reaches the set level(-3%). It switches off when the humidity drops below the set level and after the selected period on the overrun timer.

The humidity level can be set as follows:

The overrun time can be set as follows:

Start-up timer function With the start-up timer function on ,this causes a delay of 50 seconds before the fan switches on via the external switch. if the switched live is on for less then 50 seconds the fan will not switch on .

Factory settings

Interval function	Off
Interval time	4 hours
Humidistat	60% RH
Timer	1 min.
Start-up timer function	Off

WIRING FOR MODELS WITH HUMIDITY SENSOR.

Humidity Models provided with an electronic humidistat which can be adjusted from 60% to 90 % RH (Relative Humidity) and with a timer, adjustable between 1 ,5,15 or 30 minutes. The desired humidity level and run on time are selected by means of 8 dip-switches placed on the printed circuit board, and easily accessible. Each dip-switch has two positions [ON (1) and OFF (0)] which are selected with a small screwdriver supplied with the fan:

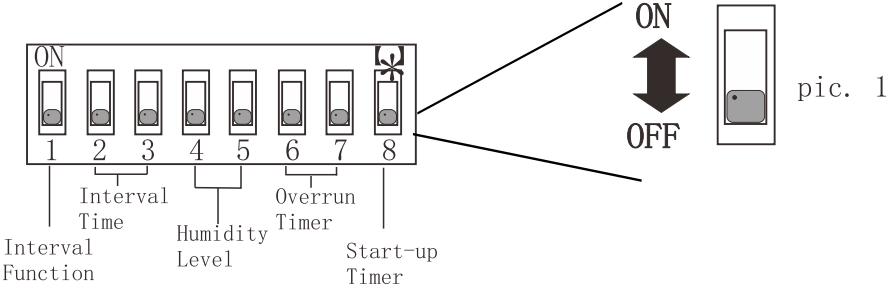

Automatic operation:

The extractor is connected to the main supply with only two wires. (see pic.2). The humidistat causes the extractor to operate automatically when the humidity level in the room is higher than the set level. The extractor will stop automatically when the humidity drops below the selected level (-3%) and after the selected period set on the over-run timer.

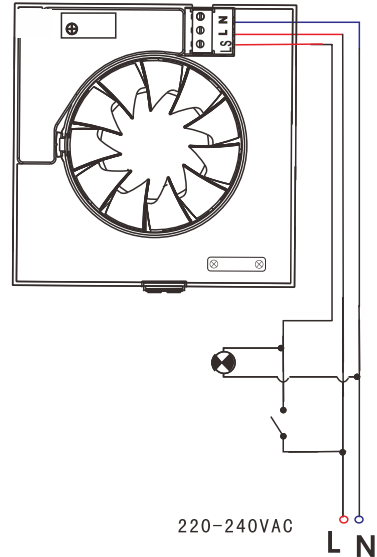
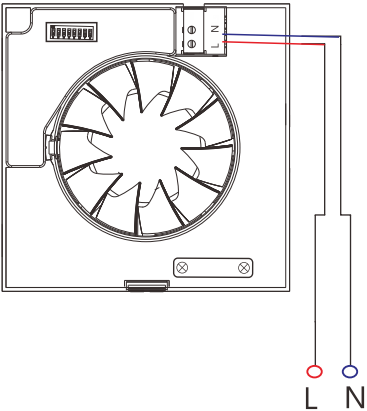

Automatic operation with external switch to override the extractor :

The extractor is connected to the main supply with three wires. (see pic. 3)
Operation as previous "Automatic operation", with the facility to override the humidistat by means of the light switch when the humidity level in the room is lower than the selected level. In this case the extractor continues to operate for the selected period of time (over-run timer) after the switch light has been switched off.

ATENTION: When the humidity rate is above the selected value, the automatic option takes precedence over the manual and the unit cannot then be switched off using a switch.

Adjust the dip-switch to the required settings

Interval function

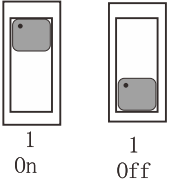

With the interval function on , the fan operates irrespective of humidity. This is useful to prevent the fan running constantly where humidity levels are consistently high ,for example near the sea. It also allows the fan to operate when humidity levels are consistently low, for example when installed near a heating appliance.
The fan switches on automatically for one hour ,irrespective of the humidity level ,switches off for the interval set ,then switches on again for one hour, etc.

Interval time

The interval time can be set as follows:

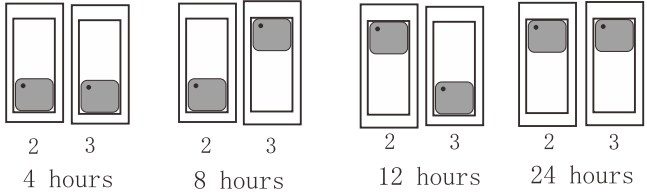

Humidity function

The humidistat causes the fan to operate when the humidity level reaches the set level(-3%). It switches off when the humidity drops below the set level and after the selected period on the overrun timer.

The humidity level can be set as follows:

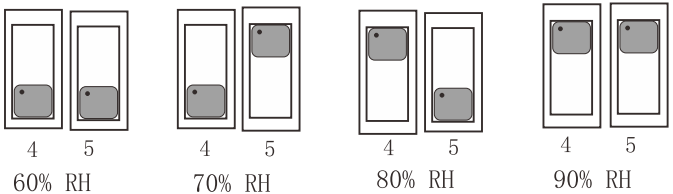

The overrun time can be set as follows:

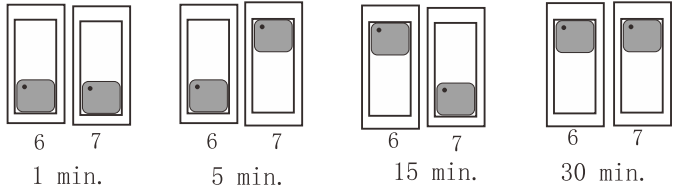

Start-up timer function

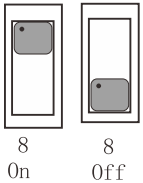

With the start-up timer function on ,this causes a delay of 50 seconds before the fan switches on via the external switch. if the switched live is on for less then 50 seconds the fan will not switch on .

Factory settings

Interval function	Off
Interval time	4 hours
Humidistat	60% RH
Timer	1 min.
Start-up timer function	Off